



FT 288/2



MATERIALS

| | |
|---------------------|--|
| VALVE BODY | 11 S MN Pb 30 - UNI EN 10087 |
| ADJUSTING | 11 S MN Pb 30 - UNI EN 10087 |
| COMPENSATION | STEEL 38 Ni CR Mo 5 - UNI EN 10083 HEAT TREATED |
| HANDWHEEL | GD AL SI - UNI EN AB 46100 |
| NIPPLE | NYLON 6 |
| OR | NITRILE |
| ANTIEXTRUSION RINGS | PTFE |

All components are surface treated and protected

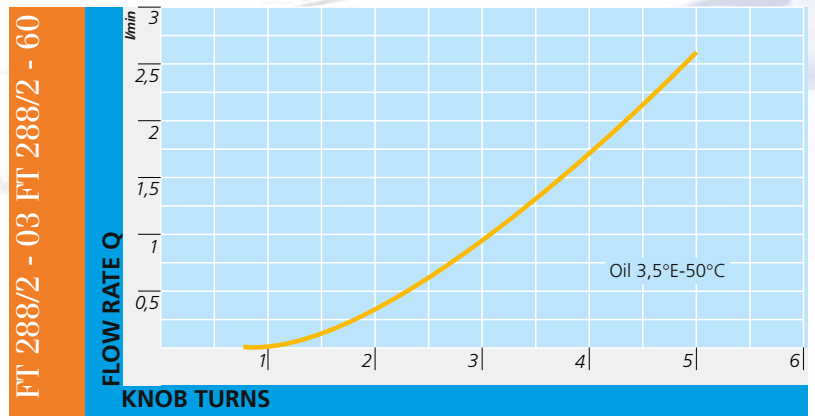
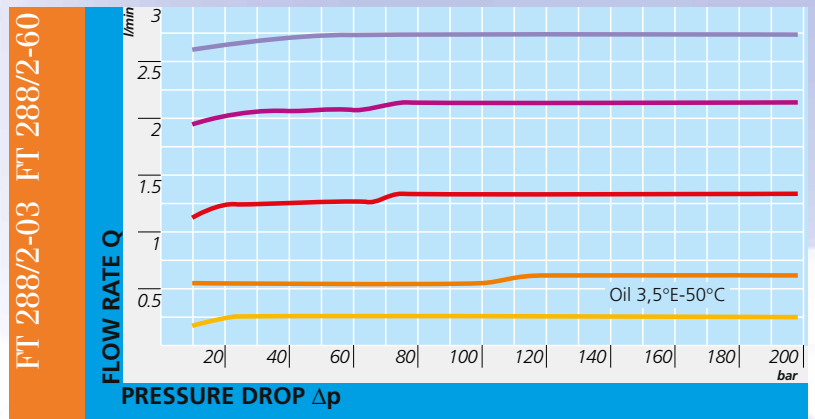



PRESSURE COMPENSATED MICROFINE FLOW CONTROL PLATE VALVES

They are the equivalent version with panel mounting as the regulators series FT 297/2 with threaded cartridge.
Suitable for the adjustment of reduced flow rate with a high precision and stability level. They are provided with plate connections mod. CETOP 03 or interchangeable with the broadly used valves. The connection seals are equipped in series. The sealings are supplied in series.
Max. working pressure 250 bar.



FT 288/2

EXAMPLE FOR ORDERING

| CODE | TYPE |
|----------|------|
| FT 288/2 | 60 |

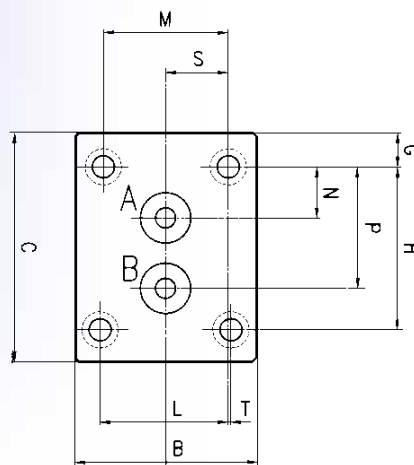
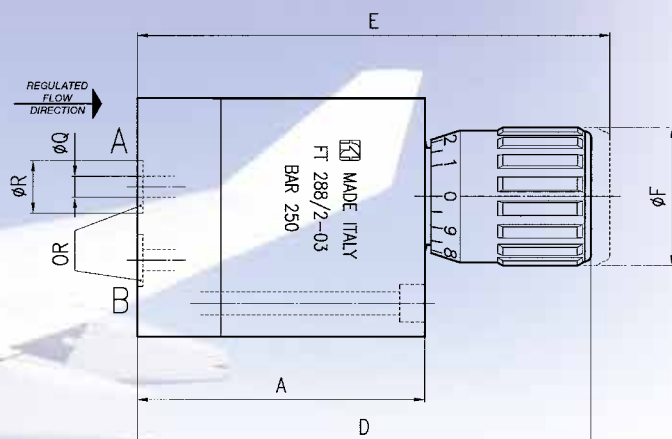

DIMENSIONS

| TYPE | A | B | C | D | E | ØF | G | H | L | M | N | P | ØQ | ØR | S | T | OR | SCREW | WEIGHT KG |
|------|----|----|----|-----|-------|----|-----|------|-------|----|------|------|----|------|------|------|------|-------|--------------|
| 03 | 69 | 45 | 57 | 109 | 113,5 | 33 | 8,5 | 40,5 | 31,75 | 31 | 12,7 | 30,5 | 5 | 12,5 | 15,5 | 0,75 | 2037 | M5x75 | 1,285 |
| 60 | 69 | 45 | 57 | 109 | 113,5 | 33 | 8,5 | 40,5 | 31,75 | 31 | 10 | 33 | 6 | 17,2 | 15,5 | 0,75 | 2056 | M5x75 | 1,270 |



FT 289/2



MATERIALS

| | |
|---------------------|--|
| VALVE BODY | 11 S MN Pb 30 - UNI EN 10087 |
| ADJUSTING MEMBERS | 35 S MN Pb 10 - UNI EN 10087 |
| COMPENSATION PISTON | 38 NI CR MO 5 - UNI EN 10083 HEAT TREATED |
| HANDWHEEL | GD AL SI - UNI EN AB 46100 PAINTED |
| NIPPLE | NYLON 6 |
| OR | NITRILE |
| ANTIEXTRUSION RINGS | PTFE |

All components are surface treated and protected

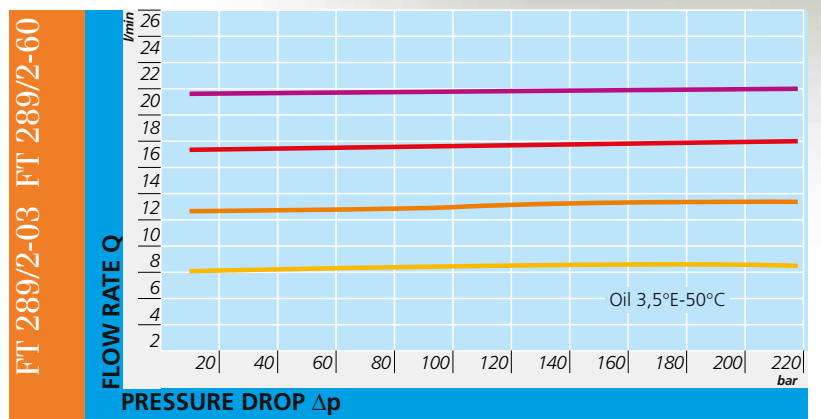
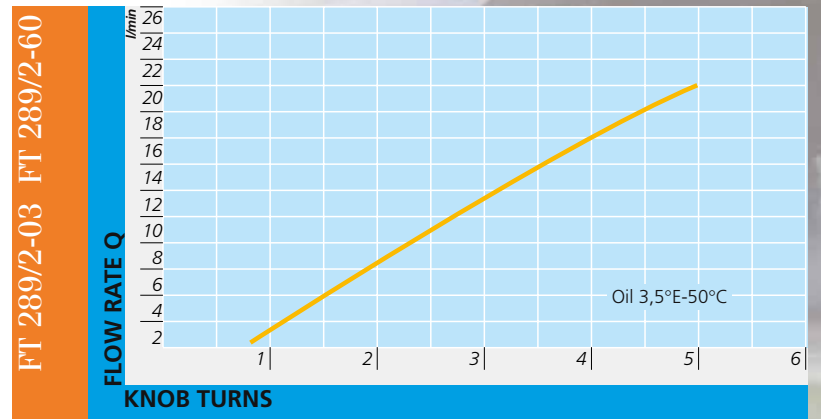

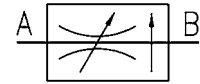

PRESSURE COMPENSATED FLOW CONTROL PLATE VALVES

They are provided with plate connections of two-port flow regulators (in line) series FT 287/2 whose main characteristics are maintained. Appreciated for the high precision level. They are provided with plate connections mod. CETOP 03 or interchangeable with the broadly used valves. The connection seals are equipped in series. The sealings are supplied in series. Max. working pressure 250 bar.



FT 289/2



EXAMPLE FOR ORDERING

| CODE | TYPE |
|----------|------|
| FT 289/2 | 03 |

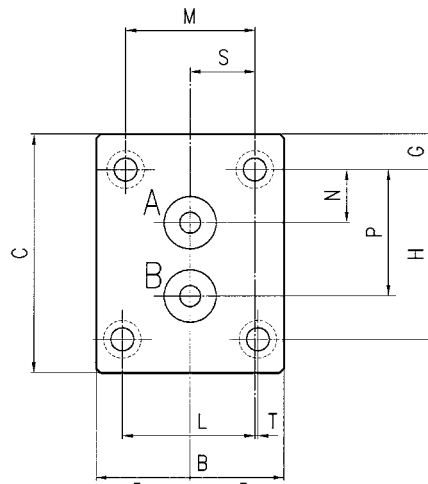
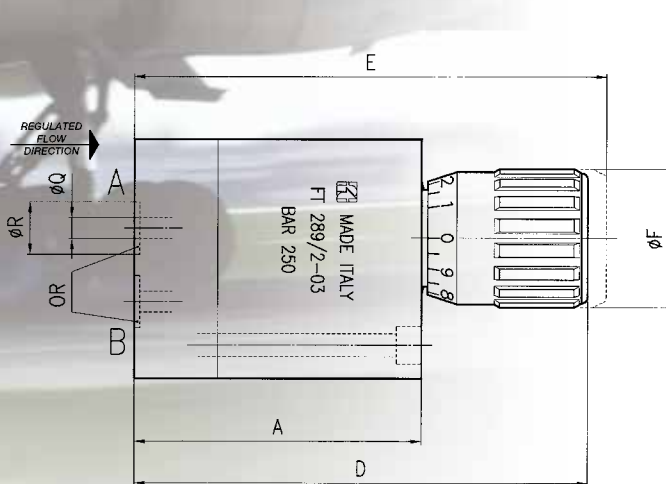

DIMENSIONS

| TYPE | A | B | C | D | E | ϕF | G | H | L | M | N | P | ϕQ | ϕR | S | T | OR | SCREW | WEIGHT |
|------|----|----|----|-----|-------|----------|-----|------|-------|----|------|------|----------|----------|------|------|------|-------|--------|
| 03 | 69 | 45 | 57 | 109 | 113,5 | 33 | 8,5 | 40,5 | 31,75 | 31 | 12,7 | 30,5 | 5 | 12,5 | 15,5 | 0,75 | 2037 | M5x75 | 1,285 |
| 60 | 69 | 45 | 57 | 109 | 113,5 | 33 | 8,5 | 40,5 | 31,75 | 31 | 10 | 33 | 6 | 17,2 | 15,5 | 0,75 | 2056 | M5x75 | 1,270 |