



CETOP 3 SUBPLATES

BS.3.01... / BS.3.0*...
CH. VII PAGE 7

BS.3.10/11... / BS.3.12/13...
BS.3.14/15... / BS.3.16/17...
CH. VII PAGE 8

BS.3.20/21... / BS.VMP.10...
BS.3.W...
CH. VII PAGE 9

BC.3.25/27... / BC.3.30/32...
BC.3.40...
CH. VII PAGE 10

BC.3.41/*...
CH. VII PAGE 11

BC.3.50... / BC.3.51...
BC.3.07... / BC.3.107...
CH. VII PAGE 12

BC.3.08... / BC.3.09...
BC.06.XQ3... / BC.06.XQP3...
CH. VII PAGE 13

BC.06.25/27...
CAP. VII PAGE 14

BC.06.30/32... / BC.06.40...
BC.06.41/*...
CH. VII PAGE 15

BM.3.**... / BM.3.60...
CH. VII PAGE 16

BM.3.50... / BM.3.70...
CH. VII PAGE 17

BM.3.52... / BM.3.72...
CH. VII PAGE 18

CMP.10...
CH. V PAGE 19

XQ.3...
CH. VIII PAGE 12

XQP.3...
CH. VIII PAGE 14

BS.3.01...

- BS** Single subplate (blanking)
- 3** CETOP 3/NG6
- 01** P / T / A / B closed
- 00** No variant
- 1** Serial No.

Weight: 0,2 Kg
Fixing screws M5x14 UNI 5931
K = plate OR (Q25.95.0001)

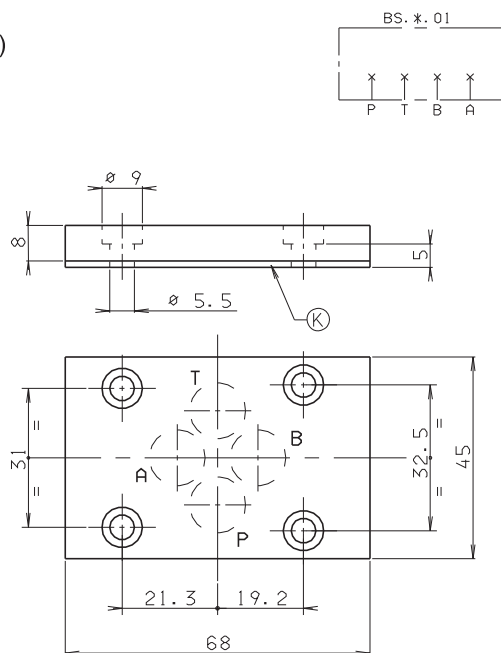

BS.3. ...**

- BS** Single subplate (blanking)
- 3** CETOP 3/NG6
- **** 02/03/04/05/06/07/08/09
- 00** No variant
- 1** Serial No.

Weight: 0,5 Kg
Fixing screws M5x30 UNI 5931

